

# SE18M

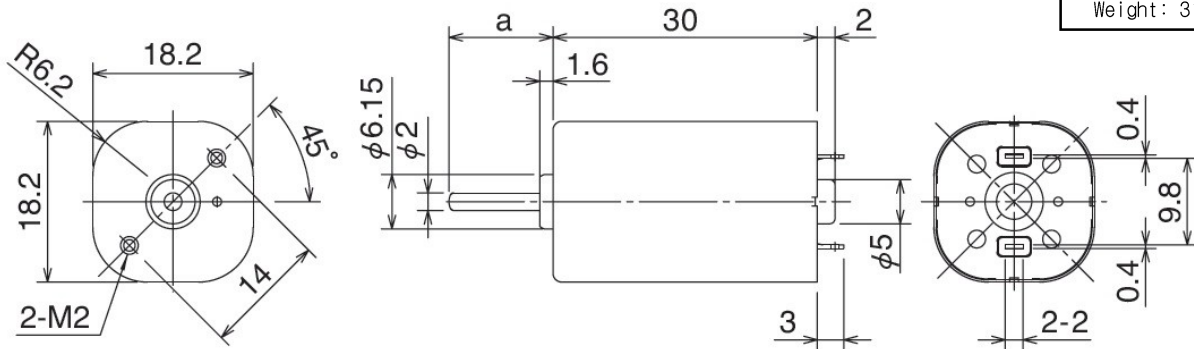

Weight: 31.7 g

## Outline UNIT:mm



## Specifications

Model	Operating Voltage (V)	Rated Voltage (V)	No Load Speed (min-1)	No Load Current (mA)	Rated Load		Rated Load Speed (min-1)	Rated Load Current (mA)	Starting Torque		Starting Current (mA)	Shaft Length a (mm)
					(gf·cm)	(mN·m)			(gf·cm)	(mN·m)		
SE18M1ETM	8 to 13	12.0	3025	43	51.0	5.0	2509	184	299.1	29.32	870	a=11.7
SE18M1LTM	8 to 13	12.0	4680	90	71.4	7.0	3934	397	448.3	43.93	2015	a=11.7

## Characteristics

